

BITEX®



BICYCLE HUBS BEST SOLUTION 2024

HUB FACTORY MADE IN TAIWAN

Professional
Perfection
Quality



Specialized in Bicycle High-End Products and Spare parts Processing

TITANIUM & STAINLESS INDUSTRY MANUFACTURING

- Source Factory with R&D team
- OEM & ODM





HUB FACTORY



www.bitexhubs.com



BITEX INDUSTRIAL CO., LTD COMPANY

The hub is important because it is the main weight-bearing component of the bike. The weight of bicycle and the rider, with all the rolling forces, bear down on the hubs. Amid today's varied and demanding bicycle-performance requirements. Bitex makes a wide range of bicycle hubs that offer :

- Superior strength & stiffness
- Longest lasting durability & reliability
- Lightest weight
- Smoothest rolling performance
- Best value
- Finest finishing colors

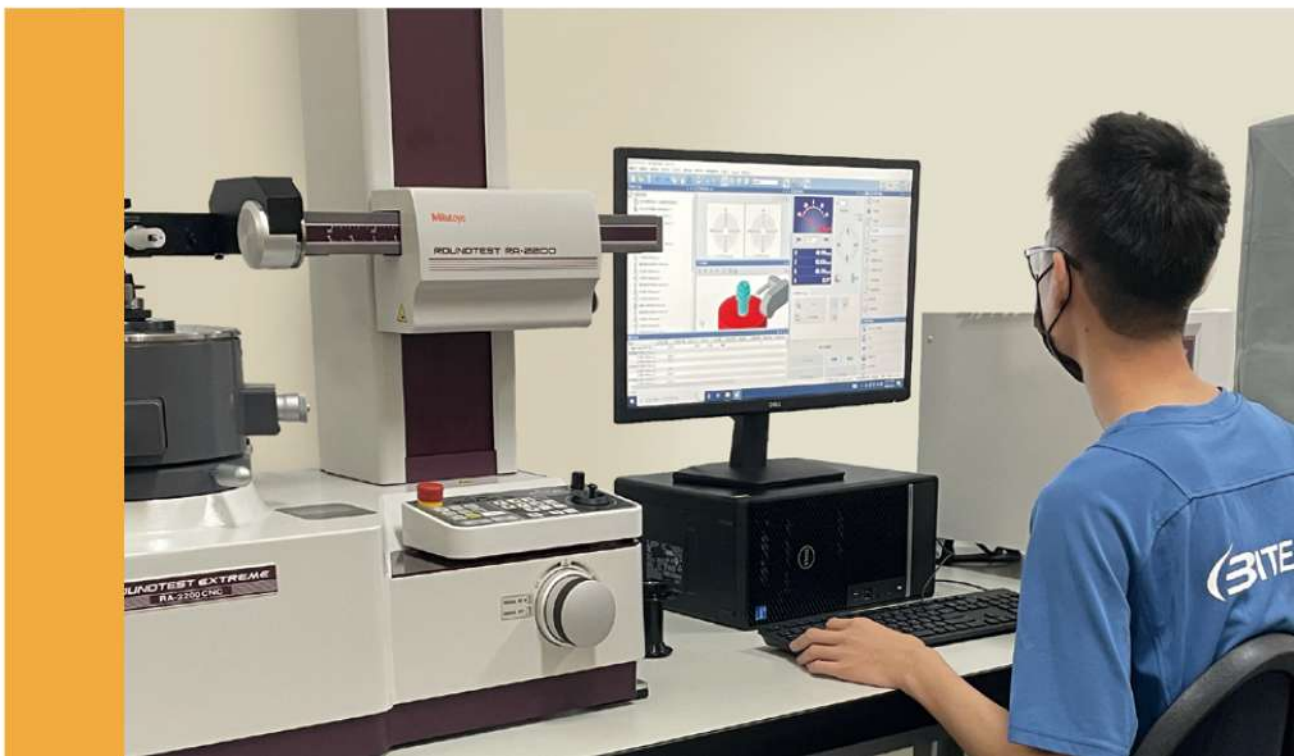

HISTORY 1923 ~ 2024

| | | |
|---|---|---|
|  | <p>2024</p> <p>DH Race Single Speed</p> |  |
|  | <p>2023</p> <p>The Innovative Design: Road : R27T (54HD) MTB : 33T (66HD)</p> |  |
|  | <p>2019</p> <p>TITANIUM technical + innovation Titanium and Stainless industry manufacturing</p> |  |
|  | <p>2017</p> | |
|  | <p>2014</p> <p>Anti-Bite System [Patented]</p> <p>54HD MTB Freehub Body / 48HD ROAD Freehub Body</p> |  |
|  | <p>2010</p> <p>4th Generation 6 Pawls System [Patented]</p> |  |
|  | <p>1978</p> <p>3rd & 4th Generation Company Name : Bitex Industrial Co., Ltd. One piece hub with aluminum tube.</p> | |
|  | <p>1947</p> <p>2nd Generation Company Name : Valisum Industrial CO., Ltd. The first company to develop coaster hub.</p> | |
|  | <p>1923</p> <p>1st Generation Name of shop : Valisum Bike Shop The first to offer : Rickshaw(1935)/Tricycle(1948)</p> | |

INDEX

| | | |
|----------------------------------|--------------------------------|----|
| Company | _____ | 02 |
| HISTORY 1923 ~ 2024 | _____ | 03 |
| Products Index | _____ | 04 |
| PATENTS Freehub Body | _____ | 04 |
| | _____ | 05 |
| | _____ | 06 |
| | _____ | 07 |
| ROAD 54HD R27T NEW | _____ | 08 |
| MTB 54HD 27T | _____ | 09 |
| 66HD 33T NEW | _____ | |
| GRAVEL | _____ | |
| STRAIGHT PULL ▶ | BX406F BX406R _____ | 10 |
| | BX317F BX317R NEW _____ | 11 |
| | BX316F BX316R NEW _____ | 11 |
| | BX312F BX315R _____ | 12 |
| J-BEND ▶ | BX106F BX108R _____ | 12 |

ROAD BIKE HUBS

| | | |
|-----------------|-----------------------------------|----|
| STRAIGHT PULL ▶ | BX313F BX313R Titanium CenterLock | 13 |
| | BX312F BX312R CenterLock | 14 |
| | BX307F BX307R | 14 |
| | BX306FG BX306R / BX305FN BX305RN | 15 |
| J-BEND ▶ | BX106F BX106R CenterLock | 16 |
| | RAF12 RAR12 / RAF10 RAR9 | 17 |
| | BX306FD RAF8 RAR8 Folding Bike | 18 |

MTB HUBS

| | | |
|-----------------|--|----|
| STRAIGHT PULL ▶ | BX407R E Bike NEW 33T / BX404F BX404R | 19 |
| | BX405F BX405R Boost CenterLock / BX402F BX402R Boost | 20 |
| J-BEND ▶ | BX218F BX218R E Bike CenterLock NEW | 21 |
| | BX217F BX217R E Bike NEW | 22 |
| | BX216F BX216R E Bike NEW 33T | 23 |
| | BX215R DH Race NEW / BX214F BX214R E-Bike | 24 |
| | BX213F BX213R Super Boost / BX212F BX212R Boost CenterLock | 25 |
| | BX211F BX211R Boost / BX211R-E-BIKE MTR12-E-BIKE E-Bike | 26 |
| | BX201FG / A20M / MTF15/20 / MTR12 | 27 |
| | FB-MTF15/20 (135/150mm) Fat Bike | 28 |
| | FB-MTR12 (170/177/190/197mm) Fat Bike | 29 |
| | BX207F BX207R / BX103F BX103R Touring Bike | 30 |

| | | |
|------------------------------|--|----|
| NEW SINGLE SPEED HUBS | BX605R | 31 |
| LEFTY HUBS | BX604F BX603F BX602F BX601F | 32 |
| TANDEM HUBS | MTR10-145 | 33 |
| TRACK HUBS | TKF10 TKR10-D (FIXED / FIXED) / TKR10-S (FIXED / FREE) | 34 |
| TRIKE / RECUMBENT BIKE | DH12N / DH15N / DH12M / DH15M / DH20M | 35 |
| WHEEL CHAIR HUBS | DH12NR8 | 35 |
| SKEWER | SK-MD01 / SK-MD02 / SK-MF42 / SK-MF46 | 36 |
| | SK-R12 / SK-FB172-174 / SK-G60 / SK-G22 | |

Freehub Body

THE SOUL OF THE BIKE.

Patented



6 Pawls System

Taiwan - M425782

China - ZL 2011 2 04061190

Germany - Nr. 20 2011 051 875.2

USA - US 8,443,951 B1

Anti-Bite

Anti-Bite System

Taiwan - M519075

China - ZL 2015 2 0925200.8

Germany - Nr. 20 2015 106 474

USA - Processing

Bitex patented 6-pawl freehub body features two sets of three, large pawls, allowing for faster engagement and greater durability.

Features

- 1). Lighter
- 2). Durable : total 6 pawls, 3 pawls one turn, 2 turns work
- 3). Smooth : **66HD(MTB)** , 54HD(MTB) , 48HD(ROAD)
high transmission efficiency
- 4). Easy to replace.
- 5). The price depends on the bearings.

Bearing option

- 1). Steel Bearings
- 2). Stainless Steel Bearings
- 3). Ceramic Bearings
- 4). Japanese Ceramics Bearings



6 Pawls System

Work smooth and high transmission efficiency

How it works

New and improved design.

Two sets of three pawls - six in total - reduction in distance between points of engagement by 50%.



A team



B team

Anti-Bite Anti-Bite System

One of the most common complaints about Alloy freehub bodies is how easily they can be gouged by cassettes, leaving ugly notches that make removing the cassette difficult. Introducing the new Bitex "Anti-Bite System" - three small, hardened stainless splines to our patented 6-pawl freehub body that will absorb the pressure of the steel cassette. Customers asked for a solution to freehub gouging, and we've delivered it.

Innovative design

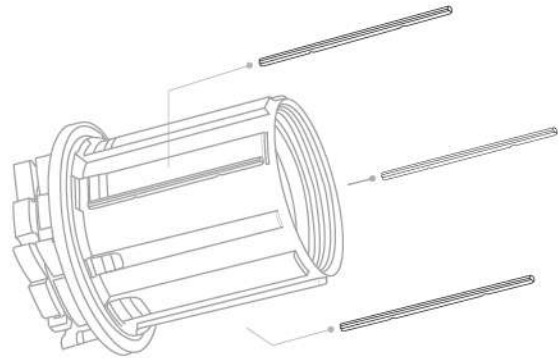

With Anti-Bite

Stainless Splines
x 3



Stainless steel splines on our Shimano freehubs without increasing weight.

► FREEHUB BODY

ROAD **54HD** **R27T**



Shimano 11s
Titanium
R09-KHF2
106g ± 5g



SRAM XDR 12s
Aluminum
R09-THB2
68g ± 5g



Shimano 11s
Aluminum
R09T-NHC2
65g ± 5g



Campagnolo NEW 13s
Aluminum
R09-VHA2
70.7g ± 5g



Shimano 11s
Aluminum
R09T-EHC2
70g ± 5g



Campagnolo 10/11/12s
Aluminum
R09-QHB2
74g ± 5g



Shimano 11s
Aluminum
R09T-FHB2
77g ± 5g

MTB 54HD 27T



Shimano Micro Spline 12s
Aluminum / 74g ± 5g
R07-JHA2



Shimano Micro Spline 12s
Steel / 158g ± 5g
R08-DBBH-B2



Shimano 11s
Aluminum
R07T-GHD2
80g ± 5g



(For E-Bike)
Shimano 11s
Steel
R08-ABBH-B5
160g ± 5g



SRAM XD 12s
Aluminum
R07-SHB2
72g ± 5g



SRAM XD 12s
Steel
R08-BBBH
127g ± 5g



Shimano 11s
Titanium
R07-LHF2
111g ± 5g

MTB 66HD 33T



Shimano 11s
Aluminum
R07T-1HD2 **NEW**
98g ± 5g



SRAM XD 11s
Aluminum
R07-3HD2 **NEW**
87g ± 5g

GRAVEL BIKE HUBS



BX406F

| | |
|-----------------|-----------------|
| Brake Interface | Disc (6-bolts) |
| Spoke System | Straight Pull |
| Hole Count | 24 |
| Weight | 140g ± 5g (15M) |
| Material | Aluminum |
| Gauge | 14 |
| Bearings | ◎ 2 (6803*2) |
| P.C.D | ∅56 - ∅42 (24H) |
| Axle system | 12M/100mm |



BX406R

| | |
|-----------------|--------------------------------------|
| Brake Interface | Disc (6-bolts) |
| Spoke System | Straight Pull |
| Hole Count | 24 |
| Weight | 302g ± 5g |
| Material | Aluminum |
| Gauge | 14 |
| Bearings | ◎ 4 (Hub 6902*2 / Freehub 6802+6902) |
| P.C.D | ∅43 - ∅70 (24H) |
| Axle system | 12M x 142mm |

GRAVEL BIKE HUBS



BX317F **NEW**

| | |
|-----------------|---------------------|
| Brake Interface | Disc (6-bolts) |
| Spoke System | Straight Pull |
| Hole Count | 24 |
| Weight | 125g ± 5g |
| Material | Aluminum |
| Gauge | 14 |
| Bearings | ◎ 2 (6802*2) |
| P.C.D | ø56 - ø34 |
| Axle system | 12M x 100mm (Alloy) |



BX317R **NEW**

| | |
|-----------------|---|
| Brake Interface | Disc (6-bolts) |
| Spoke System | Straight Pull |
| Hole Count | 24 |
| Weight | 290g ± 5g |
| Material | Aluminum |
| Gauge | 14 |
| Bearings | ◎ 4 (Hub 6802+6902 / Freehub 6802+6902) |
| P.C.D | ø43 - ø70 |
| Axle system | 12M x 142mm - 35g (Alloy) |



BX316F **NEW**

| | |
|-----------------|------------------------------------|
| Brake Interface | CenterLock |
| Spoke System | Straight Pull |
| Hole Count | 24 , 28 |
| Weight | 109g ± 5g |
| Material | Aluminum |
| Gauge | 14 |
| Bearings | ◎ 2 (6903*2) |
| P.C.D | ø36 - ø36 (24H) ø46 - ø46 (28H) |
| Axle system | M9(QR)/12M/15M x 100mm |



BX316R **NEW**

| | |
|-----------------|--|
| Brake Interface | CenterLock |
| Spoke System | Straight Pull |
| Hole Count | 24 , 28 |
| Weight | 240g ± 5g |
| Material | Aluminum |
| Gauge | 14 |
| Bearings | ◎ 2 (6903*2) |
| P.C.D | ø35 - ø49 (24H) |
| Axle system | ø49 - ø49 (28H) 12M/142mm - 35g (Alloy) |

GRAVEL BIKE HUBS



BX312F

| | |
|-----------------|------------------------------------|
| Brake Interface | CenterLock |
| Spoke System | Straight Pull |
| Hole Count | 24 , 28 |
| Weight | 105g ± 5g (12M) |
| Material | Aluminum |
| Gauge | 14 |
| Bearings | ◎ 2 (6803*2) |
| P.C.D | ø36 - ø36 (24H) ø46 - ø46 (28H) |
| Axle system | M9(QR)/12M/15M x 100mm |



BX315R

| | |
|-----------------|---|
| Brake Interface | CenterLock |
| Spoke System | Straight Pull |
| Hole Count | 24 , 28 |
| Weight | 226g ± 5g |
| Material | Aluminum |
| Gauge | 14 |
| Bearings | ◎ 4 (Hub 6802+6902 / Freehub 6802+6902) |
| P.C.D | ø 35 - ø51 (24H) ø 51 - ø51 (28H) |
| Axle system | 12M x 142mm - 35g (Alloy) |



BX106F

| | |
|-----------------|------------------------|
| Brake Interface | CenterLock |
| Spoke System | J-Bend |
| Hole Count | 24 , 28 , 32 |
| Weight | 114g ± 5g |
| Material | Aluminum |
| Gauge | 14 |
| Bearings | ◎ 2 (6902*2) |
| P.C.D | ø45 - ø45 |
| Axle system | M9(QR)/12M/15M x 100mm |



BX108R

| | |
|-----------------|--------------------------------------|
| Brake Interface | CenterLock |
| Spoke System | J-Bend |
| Hole Count | 24 , 28 , 32 , 36 |
| Weight | 259g ± 5g |
| Material | Aluminum |
| Gauge | 14 |
| Bearings | ◎ 4 (Hub 6902*2 / Freehub 6802+6902) |
| P.C.D | ø45 - ø58 |
| Axle system | 12M x 142mm - 35g (Alloy) |

 ROAD BIKE HUBS

TITANIUM

TECHNICAL + INNOVATION



BX313F

| | |
|-----------------|--------------------|
| Brake Interface | CenterLock |
| Spoke System | Straight Pull |
| Hole Count | 24 |
| Weight | 122g ± 5g (12M) |
| Material | Titanium |
| Gauge | 14 |
| Bearings | ⊙ 2 (6803*2) |
| P.C.D | ø36 - ø36 |
| Axle system | M9(QR)/12M x 100mm |



BX313R

| | |
|-----------------|---|
| Brake Interface | CenterLock |
| Spoke System | Straight Pull |
| Hole Count | 24 |
| Weight | 281g ± 5g (12M x 142mm) |
| Material | Titanium |
| Gauge | 14 |
| Bearings | ⊙ 5 (Hub 6802 + 6902 / Freehub body 6802*2+6902) |
| P.C.D | ø35 - ø49 |
| Axle system | M10(QR) x 135mm - 47.5g (Axle : Alloy) 12M x 142mm - 35g (Alloy) |

ROAD BIKE HUBS



BX312F **CenterLock**

| | |
|-----------------|------------------------------------|
| Brake Interface | CenterLock |
| Spoke System | Straight Pull |
| Hole Count | 24 , 28 |
| Weight | 105g ± 5g (12M) |
| Material | Aluminum |
| Gauge | 14 |
| Bearings | ◎ 2 (6803*2) |
| P.C.D | ∅36 - ∅36 (24H) ∅46 - ∅46 (28H) |
| Axle system | M9 (QR) / 12M /15M x 100mm |



BX312R **CenterLock**

| | |
|-----------------|--|
| Brake Interface | CenterLock |
| Spoke System | Straight Pull |
| Hole Count | 24 , 28 |
| Weight | 224g ± 5g (12M X 142mm) |
| Material | Aluminum |
| Gauge | 14 |
| Bearings | ◎ 4 (Hub 6802+6902 / Freehub 6802+6902) |
| P.C.D | ∅35 - ∅51 (24H) ∅51 - ∅51 (28H) |
| Axle system | M10(QR) x 135mm - 47.5g (Alloy) 12M x 142mm - 35g (Alloy) |



BX307F

| | |
|-----------------|-------------------|
| Brake Interface | V Brake |
| Spoke System | Straight Pull |
| Hole Count | 16 , 18 , 20 , 24 |
| Weight | 82g ± 5g |
| Material | Aluminum |
| Gauge | 14 |
| Bearings | ◎ 2 (699*2) |
| P.C.D | ∅34 - ∅34 |
| Axle system | M9(QR) x 100mm |



BX307R

| | |
|-----------------|---|
| Brake Interface | V Brake |
| Spoke System | Straight Pull |
| Hole Count | 7/14 , 8/16 |
| Weight | 260g ± 5g |
| Material | Aluminum |
| Gauge | 14 |
| Bearings | ◎ 4 (Hub 6802+6902 / Freehub 6802+6902) |
| P.C.D | ∅42 - ∅68 |
| Axle system | M10(QR) x 130mm |

ROAD BIKE HUBS



BX306FG

| | |
|-----------------|------------------------|
| Brake Interface | Disc (6-bolts) |
| Spoke System | Straight Pull |
| Hole Count | 20 , 24 |
| Weight | 110g ± 5g |
| Material | Aluminum |
| Gauge | 14 |
| Bearings | ◎ 2 (6803*2) |
| P.C.D | ø 36 - ø36 |
| Axle system | M9(QR)/12M/15M x 100mm |



BX306R

| | |
|-----------------|--|
| Brake Interface | Disc (6-bolts) |
| Spoke System | Straight Pull |
| Hole Count | 24 |
| Weight | 242g ± 5g (M10 x 135mm) |
| Material | Aluminum |
| Gauge | 14 |
| Bearings | ◎ 4 (Hub 6802+6902/Freehub 6802+6902) |
| P.C.D | ø 35 - ø49 |
| Axle system | M10(QR) x 135mm - 47.5g (Alloy) 12M x 142mm - 35g (Alloy) |



BX305FN Light Weight

| | |
|-----------------|---------------|
| Brake Interface | V Brake |
| Spoke System | Straight Pull |
| Hole Count | 20 |
| Weight | 65g ± 5g |
| Material | Aluminum 7075 |
| Gauge | 14 |
| Bearings | ◎ 2 (699*2) |
| P.C.D | ø 28 - ø28 |
| Axle system | M9(QR)/100mm |



BX305RN Light Weight

| | |
|-----------------|--|
| Brake Interface | V Brake |
| Spoke System | Straight Pull |
| Hole Count | 20 , 24 |
| Weight | 193g ± 5g |
| Material | Aluminum 7075 |
| Gauge | 14 |
| Bearings | ◎ 4 (Hub 6802*2 / Freehub 6802*2) |
| P.C.D | ø35 - ø49 |
| Axle system | M10(QR) x 130mm - 45g (Alloy) M10(QR) x 135mm - 47g (Alloy) |

ROAD BIKE HUBS



BX106F

| | |
|-----------------|------------------------|
| Brake Interface | CenterLock |
| Spoke System | J-Bend |
| Hole Count | 24 , 28 , 32 |
| Weight | 114g ± 5g |
| Material | Aluminum |
| Gauge | 14 |
| Bearings | ◎ 2 (6902*2) |
| P.C.D | ø45 - ø45 |
| Axle system | M9(QR)/12M/15M x 100mm |



BX106R

| | |
|-----------------|--|
| Brake Interface | CenterLock |
| Spoke System | J-Bend |
| Hole Count | 24 , 28 , 32 |
| Weight | 250g ± 5g (12M x 142mm) |
| Material | Aluminum |
| Gauge | 14 |
| Bearings | ◎ 4 (Hub 6902*2 / Freehub 6802+6902) |
| P.C.D | ø45 - ø50.6 |
| Axle system | M10(QR) x 135mm - 47.5g (Alloy) 12M x 142mm - 35g (Alloy) |

ROAD HUBS

ROAD BIKE HUBS



RAF12

| | |
|-----------------|-------------------|
| Brake Interface | V Brake |
| Spoke System | J-Bend |
| Hole Count | 20 , 24 , 28 , 32 |
| Weight | 78g ± 5g |
| Material | Aluminum |
| Gauge | 14 |
| Bearings | ◎ 2 (6900*2) |
| P.C.D | ø31 - ø31 |
| Axle system | M9(QR) x 100mm |



RAR12

| | |
|-----------------|--|
| Brake Interface | V Brake |
| Spoke System | J-Bend |
| Hole Count | 7/14 , 8/16 , 24 , 28 , 32 |
| Weight | 221g ± 5g |
| Material | Aluminum |
| Gauge | 14 |
| Bearings | ◎ 4 (Hub 6802+6902 / Freehub 6802+6902) |
| P.C.D | ø38.5 - ø50.6 |
| Axle system | M10(QR) x 130mm - 45g (Alloy) M10(QR) x 135mm - 47g (Alloy) |



RAF10

| | |
|-----------------|----------------|
| Brake Interface | V Brake |
| Spoke System | J-Bend |
| Hole Count | 16 , 18 , 20 |
| Weight | 65g ± 5g |
| Material | Aluminum |
| Gauge | 14 |
| Bearings | ◎ 4 (688*4) |
| P.C.D | ø30 - ø30 |
| Axle system | M9(QR) x 100mm |



RAR9

| | |
|-----------------|--|
| Brake Interface | V Brake |
| Spoke System | J-Bend |
| Hole Count | 7/14 , 8/16 , 20 , 24 |
| Weight | 200g ± 5g |
| Material | Aluminum |
| Gauge | 14 |
| Bearings | ◎ 4 (Hub 6802*2 / Freehub 6802*2) |
| P.C.D | ø38.5 - ø50.6 |
| Axle system | M10(QR) x 130 mm - 45g (Alloy) M10(QR) x 135 mm - 47g (Alloy) |

FOLDING BIKE HUBS



BX306FD

| | |
|-----------------|-------------------|
| Brake Interface | Disc (6-bolts) |
| Spoke System | Straight Pull |
| Hole Count | 20 |
| Weight | 85.3g ± 5g (74mm) |
| Material | Aluminum |
| Gauge | 14 |
| Bearings | ◎ 2 (6802*2) |
| P.C.D | ø32 - ø32 |
| Axle system | M9(QR) x 74/100mm |



RAF8

| | |
|-----------------|----------------------|
| Brake Interface | V Brake |
| Spoke System | J-Bend |
| Hole Count | 16 , 18 , 20 , 24 |
| Weight | 65g ± 5g (M9 x 74mm) |
| Material | Aluminum |
| Gauge | 14 |
| Bearings | ◎ 2 (699*2) |
| P.C.D | ø30 - ø30 |
| Axle system | M9(QR) x 74/85/100mm |



RAR8

| | |
|-----------------|--------------------------------------|
| Brake Interface | V Brake |
| Spoke System | J-Bend |
| Hole Count | 7/14 , 8/16 , 24 , 28 |
| Weight | 202g ± 5g (M10 x 120mm) |
| Material | Aluminum |
| Gauge | 14 |
| Bearings | ◎ 4 (Hub 6802*2 / Freehub 6802+6902) |
| P.C.D | ø38.5 - ø50.6 |
| Axle system | M10(QR) x 120/130mm |

MTB HUBS



BX407R NEW 33T

| | |
|-----------------|---|
| Brake Interface | Disc (6-bolts) |
| Spoke System | Straight Pull |
| Hole Count | 24 , 28 |
| Weight | 330g ± 5g |
| Material | Aluminum |
| Gauge | 14 |
| Bearings | ⊙ 4 (Hub 6902+6903 / Freehub 17287+6902) |
| P.C.D | ø39 - ø64 |
| Axle system | 12M x 148mm (Aluminum) (OD : 17mm / ID : 12mm) |



BX404F

| | |
|-----------------|----------------|
| Brake Interface | Disc (6-bolts) |
| Spoke System | Straight Pull |
| Hole Count | 24 , 28 |
| Weight | 142g ± 5g |
| Material | Aluminum |
| Gauge | 14 |
| Bearings | ⊙ 2 (6903*2) |
| P.C.D | ø56 - ø43 |
| Axle system | 15M x 110mm |



BX404R

| | |
|-----------------|--------------------------------------|
| Brake Interface | Disc (6-bolts) |
| Spoke System | Straight Pull |
| Hole Count | 24 , 28 |
| Weight | 321g ± 5g |
| Material | Aluminum |
| Gauge | 14 |
| Bearings | ⊙ 4 (Hub 6902*2 / Freehub 6802+6902) |
| P.C.D | ø39 - ø56 |
| Axle system | 12M x 148mm - 86g (Steel) |

MTB HUBS



BX405F

| | |
|-----------------|---------------|
| Brake Interface | Centerlock |
| Spoke System | Straight Pull |
| Hole Count | 24 , 28 |
| Weight | 145g ± 5g |
| Material | Aluminum |
| Gauge | 14 |
| Bearings | ◎ 2 (6902*2) |
| P.C.D | ø43 - ø43 |
| Axle system | 15M x 110mm |



BX405R

| | |
|-----------------|--------------------------------------|
| Brake Interface | Centerlock |
| Spoke System | Straight Pull |
| Hole Count | 24 , 28 |
| Weight | 312g ± 5g |
| Material | Aluminum |
| Gauge | 14 |
| Bearings | ◎ 4 (Hub 6902*2 / Freehub 6802+6902) |
| P.C.D | ø39 - ø54 |
| Axle system | 12M x 148mm - 86g (Steel) |



BX402F

| | |
|-----------------|----------------|
| Brake Interface | Disc (6-bolts) |
| Spoke System | Straight Pull |
| Hole Count | 28 , 32 |
| Weight | 167g ± 5g |
| Material | Aluminum |
| Gauge | 14 |
| Bearings | ◎ 2 (6903*2) |
| P.C.D | ø55 - ø55 |
| Axle system | 15M x 110mm |



BX402R

| | |
|-----------------|--------------------------------------|
| Brake Interface | Disc (6-bolts) |
| Spoke System | Straight Pull |
| Hole Count | 28 , 32 |
| Weight | 365g ± 5g |
| Material | Aluminum |
| Gauge | 14 |
| Bearings | ◎ 4 (Hub 6903*2 / Freehub 6802+6902) |
| P.C.D | ø55 - ø55 |
| Axle system | 12M x 148mm - 86g (Steel) |



FOR
ROCKSHOX

E-BIKE HUBS



BX218F NEW

| | |
|-----------------|---------------------|
| Brake Interface | CenterLock |
| Spoke System | J-Bend |
| Hole Count | 32 , 36 |
| Weight | 174g ± 5g |
| Material | Aluminum |
| Gauge | 14 |
| Bearings | ◎ 4 (6902*4) |
| P.C.D | ø58 - ø45 |
| Axle system | 15M x 110mm (Alloy) |



BX218R NEW

| | |
|-----------------|--|
| Brake Interface | CenterLock |
| Spoke System | J-Bend |
| Hole Count | 32 , 36 |
| Weight | 417g ± 5g |
| Material | Aluminum |
| Gauge | 14 |
| Bearings | ◎ 6 (Hub 6902*3 / Freehub 6802*2+6902) |
| P.C.D | ø58 - ø58 |
| Axle system | 12M x 148mm - 86g (Steel) M10 (QR) x 141mm - 109g (Steel) |

E-BIKE HUBS

BX217F NEW

| | |
|-----------------|---------------------|
| Brake Interface | Disc (6-bolts) |
| Spoke System | J-Bend |
| Hole Count | 32 , 36 |
| Weight | 181g ± 5g |
| Material | Aluminum |
| Gauge | 14 |
| Bearings | ◎ 4 (6803*4) |
| P.C.D | ø58 - ø45 |
| Axle system | 15M x 110mm (Alloy) |



BX217R NEW

| | |
|-----------------|---|
| Brake Interface | Disc (6-bolts) |
| Spoke System | J-Bend |
| Hole Count | 32 , 36 |
| Weight | 430g ± 5g |
| Material | Aluminum |
| Gauge | 14 |
| Bearings | ◎ 6 (Hub 6902*3 / Freehub 6802*2+6902) |
| P.C.D | ø58 - ø58 |
| Axle system | 12M x 148mm - 86g (Steel) M10(QR) x 141mm - 108g (Steel) |



E-BIKE HUBS



BX216F NEW

| | |
|-----------------|----------------|
| Brake Interface | Disc (6-bolts) |
| Spoke System | J-Bend |
| Hole Count | 28 , 32 , 36 |
| Weight | 156g ± 5g |
| Material | Aluminum |
| Gauge | 14 |
| Bearings | ◎ 2 (6903*2) |
| P.C.D | ø58 - ø58 |
| Axle system | 15M x 110mm |



BX216R NEW 33T

| | |
|-----------------|---|
| Brake Interface | Disc (6-bolts) |
| Spoke System | J-Bend |
| Hole Count | 28 , 32 , 36 |
| Weight | 346g ± 5g |
| Material | Aluminum |
| Gauge | 14 |
| Bearings | ◎ 4 (Hub 6902+6903 / Freehub 17287+6902) |
| P.C.D | ø60 - ø60 |
| Axle system | 12M x 148mm (Aluminum) (OD : 17mm / ID : 12mm) |

E-BIKE HUBS

DH Race.

Superboost 150 or 157mm with short freewheel body for DH Race 6 or 7 speed cassette



BX215R NEW

| | |
|-----------------|---|
| Brake Interface | Disc (6-bolts) |
| Spoke System | J-Bend |
| Hole Count | 28, 32, 36 |
| Weight | 307g ± 5g |
| Material | Aluminum |
| Gauge | 14 |
| Bearings | ◎ 4 (Hub 6903*2 / Freehub 6802+6902)(Steel) |
| P.C.D | ø60 - ø60 |
| Axle system | 12M x 150mm (Steel) |

*Freehub Body Material : Steel



BX214F

| | |
|-----------------|----------------|
| Brake Interface | Disc (6-bolts) |
| Spoke System | J-Bend |
| Hole Count | 28, 32, 36 |
| Weight | 145g ± 5g |
| Material | Aluminum |
| Gauge | 14 |
| Bearings | ◎ 2 (6903*2) |
| P.C.D | ø58 - ø45 |
| Axle system | 15M x 110mm |



BX214R

| | |
|-----------------|--|
| Brake Interface | Disc (6-bolts) |
| Spoke System | J-Bend |
| Hole Count | 32, 36 |
| Weight | 405g ± 5g |
| Material | Aluminum |
| Gauge | 14 |
| Bearings | ◎ 5 (Hub 6902*2 / Freehub 6802*2+6902) |
| P.C.D | ø58 - ø58 |
| Axle system | 12M x 148mm - 86g (Steel) |

*Freehub Body Material : Steel

BOOST HUBS



BX213F

| | |
|-----------------|----------------|
| Brake Interface | Disc (6-bolts) |
| Spoke System | J-Bend |
| Hole Count | 28 , 32 |
| Weight | 180g ± 5g |
| Material | Aluminum |
| Gauge | 14 |
| Bearings | ◎ 2 (6805*2) |
| P.C.D | ø58 - ø49 |
| Axle system | 20M x 110mm |



BX213R SUPER BOOST

| | |
|-----------------|--------------------------------------|
| Brake Interface | Disc (6-bolts) |
| Spoke System | J-Bend |
| Hole Count | 28 , 32 |
| Weight | 323g ± 5g |
| Material | Aluminum |
| Gauge | 14 |
| Bearings | ◎ 4 (Hub 6902*2 / Freehub 6802+6902) |
| P.C.D | ø58 - ø58 |
| Axle system | 12M x 157mm - 81g (Steel) |



BX212F

| | |
|-----------------|------------------------|
| Brake Interface | CenterLock |
| Spoke System | J-Bend |
| Hole Count | 28 , 32 |
| Weight | 142g ± 5g |
| Material | Aluminum |
| Gauge | 14 |
| Bearings | ◎ 2 (6902*2) |
| P.C.D | ø58 - ø45 |
| Axle system | M9(QR)/12M/15M x 110mm |



BX212R

| | |
|-----------------|--------------------------------------|
| Brake Interface | CenterLock |
| Spoke System | J-Bend |
| Hole Count | 28 , 32 |
| Weight | 308g ± 5g |
| Material | Aluminum |
| Gauge | 14 |
| Bearings | ◎ 4 (Hub 6902*2 / Freehub 6802+6902) |
| P.C.D | ø58 - ø58 |
| Axle system | 12M x 148mm - 86g (Steel) |

BOOST HUBS



BX211F

| | |
|-----------------|----------------|
| Brake Interface | Disc (6-bolts) |
| Spoke System | J-Bend |
| Hole Count | 28 , 32 |
| Weight | 141g ± 5g |
| Material | Aluminum |
| Gauge | 14 |
| Bearings | ◎ 2 (6903*2) |
| P.C.D | ø58 - ø45 |
| Axle system | 15M x 110mm |



FOR
ROCKSHOX



BX211R

| | |
|-----------------|--------------------------------------|
| Brake Interface | Disc (6-bolts) |
| Spoke System | J-Bend |
| Hole Count | 28 , 32 |
| Weight | 319g ± 5g (12M x 148mm) |
| Material | Aluminum |
| Gauge | 14 |
| Bearings | ◎ 4 (Hub 6902*2 / Freehub 6802+6902) |
| P.C.D | ø58 - ø58 |
| Axle system | 12M x 148mm - 86g (Steel) |



BX211R-E-BIKE

| | |
|-----------------|--|
| Brake Interface | Disc (6-bolts) |
| Spoke System | J-Bend |
| Hole Count | 28 , 32 , 36 |
| Weight | 385g ± 5g |
| Material | Aluminum |
| Gauge | 14 |
| Bearings | ◎ 5 (Hub 6902*2 / Freehub 6802*2+6902) |
| P.C.D | ø58 - ø58 |
| Axle system | 12M x 148mm - 86g (Steel) |

*Freehub Body Material : Steel



MTR12-E-BIKE

| | |
|-----------------|--|
| Brake Interface | Disc (6-bolts) |
| Spoke System | J-Bend |
| Hole Count | 28 , 32 , 36 |
| Weight | 400g ± 5g |
| Material | Aluminum |
| Gauge | 14 |
| Bearings | ◎ 5 (Hub 6902*2 / Freehub 6802*2+6902) |
| P.C.D | ø58 - ø58 |
| Axle system | 12M x 142mm - 84g (Steel) |

*Freehub Body Material : Steel

MTB HUBS



BX201FG

| | |
|-----------------|------------------------|
| Brake Interface | Disc (6-bolts) |
| Spoke System | J-Bend |
| Hole Count | 24 , 28 , 32 |
| Weight | 127g ± 5g (12M) |
| Material | Aluminum |
| Gauge | 14 |
| Bearings | ◎ 2 (6803*2) |
| P.C.D | ø58 - ø45 |
| Axle system | M9(QR)/12M/15M x 100mm |



A20M

| | |
|-----------------|-------------------|
| Brake Interface | Disc (6-bolts) |
| Spoke System | J-Bend |
| Hole Count | 24 , 28 , 32 , 36 |
| Weight | 237g ± 5g |
| Material | Aluminum |
| Gauge | 14 |
| Bearings | ◎ 2 (6805*2) |
| P.C.D | ø58 - ø58 |
| ID | 20mm |



MTF15/20

| | |
|-----------------|--|
| Brake Interface | Disc (6-bolts) |
| Spoke System | J-Bend |
| Hole Count | 24 , 28 , 32 , 36 |
| Weight | 190g ± 5g (12M) |
| Material | Aluminum |
| Gauge | 14 |
| Bearings | ◎ 2 (6804*2) |
| P.C.D | ø58 - ø58 |
| Axle system | M9(QR)/9M/12M/15M x 100mm 15M/20M x 110mm |



MTR12

| | |
|-----------------|---|
| Brake Interface | Disc (6-bolts) |
| Spoke System | J-Bend |
| Hole Count | 24 , 28 , 32 , 36 |
| Weight | 284g ± 5g (12M x 142mm) |
| Material | Aluminum |
| Gauge | 14 |
| Bearings | ◎ 4 (Hub 6902*2 / Freehub 6802+6902) |
| P.C.D | ø58 - ø58 |
| Axle system | M10(QR) x 135mm - 47.5g (Alloy) 12M x 142mm - 35g (Alloy) 12M x 142mm - 84g (Steel) |

FAT BIKE HUBS



FB-MTF15/20-135

| | |
|-----------------|----------------------------|
| Brake Interface | Disc (6-bolts) |
| Spoke System | J-Bend |
| Hole Count | 32, 36 |
| Weight | 241g ± 5g (15M x 135mm) |
| Material | Aluminum |
| Gauge | 14 |
| Bearings | ◎ 2 (6804*2) |
| P.C.D | ø58 - ø45 |
| Axle system | M9(QR)/12M/15M/20M x 135mm |



FB-MTF15/20-150

| | |
|-----------------|----------------------------|
| Brake Interface | Disc (6-bolts) |
| Spoke System | J-Bend |
| Hole Count | 32, 36 |
| Weight | 258g ± 5g (15M x 150mm) |
| Material | Aluminum |
| Gauge | 14 |
| Bearings | ◎ 2 (6804*2) |
| P.C.D | ø58 - ø58 |
| Axle system | M9(QR)/12M/15M/20M x 150mm |

Skewer SPEC. Option

QR | Skewer

M10*148.5mm(OLD:135mm)-Front

M10*167mm(OLD: 150mm)-Front

M10*190mm(OLD:170mm)-Rear

M10*210mm(OLD:190mm)-Rear

QR | Skewer : For Sram(w/o. Nut)

12M*167B(OLD:135mm)-Front

12M*202B(OLD:170mm)-Rear

12M*209B(OLD:177mm)-Rear

12M*220B(OLD:190mm)-Rear

12M*229B(OLD:197mm)-Rear

SIZE | Skewer : For Shimano(W/Nut)

12M*165B(OLD:135mm)-Front

12M*200B(OLD:170mm)-Rear

12M*207B(OLD:177mm)-Rear

12M*220B(OLD:190mm)-Rear

12M*227B(OLD:197mm)-Rear



FAT BIKE HUBS



FB-MTR12-170-177

| | |
|-----------------|--|
| Brake Interface | Disc (6-bolts) |
| Spoke System | J-Bend |
| Hole Count | 32 , 36 |
| Weight | 330g ± 5g (12M x 177mm) |
| Material | Aluminum |
| Gauge | 14 |
| Bearings | ◎ 4 (Hub 6902*2 / Freehub 6802+6902) |
| P.C.D | ø58 - ø58 |
| Axle system | For M10 - 57g (Alloy) For 12M - 38g (Alloy) |



FB-MTR12-190-197

| | |
|-----------------|--|
| Brake Interface | Disc (6-bolts) |
| Spoke System | J-Bend |
| Hole Count | 32 , 36 |
| Weight | 347g ± 5g (12M x 197mm) |
| Material | Aluminum |
| Gauge | 14 |
| Bearings | ◎ 4 (Hub 6902*2 / Freehub 6802+6902) |
| P.C.D | ø58 - ø58 |
| Axle system | For M10 - 62g (Alloy) For 12M - 41g (Alloy) |

TOURING HUBS



BX207F **For Heavy Duty**

| | |
|-----------------|------------------------|
| Brake Interface | Disc (6-bolts) |
| Spoke System | J-Bend |
| Hole Count | 24 , 28 , 32 |
| Weight | 226g ± 5g |
| Material | Aluminum |
| Gauge | 14 |
| Bearings | ◎ 4 (6804*4) |
| P.C.D | ø58 - ø45 |
| Axle system | M9(QR)/12M/15M x 100mm |



BX207R **For Heavy Duty**

| | |
|-----------------|--|
| Brake Interface | Disc (6-bolts) |
| Spoke System | J-Bend |
| Hole Count | 24 , 28 , 32 |
| Weight | 428g ± 5g (12M x 142mm / Steel) |
| Material | Aluminum |
| Gauge | 14 |
| Bearings | ◎ 6 (Hub 6902*3 / Freehub 6802*2+6902) |
| P.C.D | ø58 - ø58 |
| Axle system | M10(QR) x 135 mm - 47.5g (Alloy) 12M x 142 mm - 84g (Steel) |

*Freehub Body Material : Steel



BX103F

| | |
|-----------------|--------------------|
| Brake Interface | V Brake |
| Spoke System | J-Bend |
| Hole Count | 28 , 32 , 36 |
| Weight | 201g ± 5g (M9) |
| Material | Aluminum |
| Gauge | 14 |
| Bearings | ◎ 4 (6804*4) |
| P.C.D | ø45 - ø45 |
| Axle system | M9(QR)/15M x 100mm |



BX103R

| | |
|-----------------|---|
| Brake Interface | V Brake |
| Spoke System | J-Bend |
| Hole Count | 28 , 32 , 36 , 40 |
| Weight | 367g ± 5g (M10 x 135mm) |
| Material | Aluminum |
| Gauge | 14 |
| Bearings | ◎ 6 (Hub 6902*3 / Freehub 6802*2+6902) |
| P.C.D | ø58 - ø58 |
| Axle system | M10(QR) x 130 mm - 31g (Alloy) M10 x 135 mm - 101.5g (Steel) |

SINGLE SPEED HUBS

For special freestyle and pump track bikes
with 135mm axle single speed



SINGLE SPEED HUBS

BX605R NEW

| | |
|-----------------|---|
| Brake Interface | Disc (6-bolts) |
| Spoke System | J-Bend |
| Hole Count | 32 |
| Weight | 411g ± 5g |
| Material | Aluminum |
| Gauge | 14 |
| Bearings | ⊙ 5 (Hub 6902*2 / Steel Freehub 6802*2+6902) |
| P.C.D | ø58 - ø58 |
| Axle system | M10 x 135mm - 101.5g (Steel) |

*Freehub Body Material : Steel

LEFTY HUBS

BX604F

| | |
|-----------------|-----------------|
| Brake Interface | Disc (6-bolts) |
| Spoke System | Straight Pull |
| Hole Count | 24 |
| Weight | 113g ± 5g |
| Material | Aluminum |
| Gauge | 14 |
| Bearings | ◎ 2 (6805+6902) |
| P.C.D | ø59 - ø39 |
| Axle system | 100mm |



BX603F

| | |
|-----------------|-----------------|
| Brake Interface | Disc (6-bolts) |
| Spoke System | Straight Pull |
| Hole Count | 24, 28 |
| Weight | 112.3g ± 5g |
| Material | Aluminum |
| Gauge | 14 |
| Bearings | ◎ 2 (6805+6902) |
| P.C.D | ø60 - ø39 |
| Axle system | 110mm |



BX601F / BX602F

| | |
|-----------------|--|
| Brake Interface | Disc (6-bolts) |
| Spoke System | J-Bend |
| Hole Count | 28, 32, 36 |
| Weight | BX601F : 117g ± 5g BX602F : 120g ± 5g |
| Material | Aluminum |
| Gauge | 14 |
| Bearings | ◎ 2 (6805+6902) |
| P.C.D | ø58 - ø45 |
| Axle system | BX601F : 100mm BX602F : 110mm |

TANDEM HUBS



MTR10-145

| | |
|-----------------|--------------------------------------|
| Brake Interface | Disc (6-bolts) |
| Spoke System | J-Bend |
| Hole Count | 40 |
| Weight | 297.4g ± 5g |
| Material | Aluminum |
| Gauge | 14 |
| Bearings | ◎ 4 (Hub 6902*2 / Freehub 6802+6902) |
| P.C.D | ∅58 - ∅58 |
| Axle system | M10(QR) x 145mm |

TANDEM HUBS

▶ TRACK HUBS



TKF10

| | |
|--------------|----------------------------------|
| Spoke System | J-Bend |
| Hole Count | 20 , 24 , 28 , 32 , 36 |
| Weight | 226g ± 5g |
| Material | Aluminum |
| Gauge | 14 |
| Bearings | ◎ 2 (6000*2) |
| P.C.D | ø62 - ø62 |
| O.L.D. | 100mm |
| Axle system | 3/8" x 100/140mm, M9 x 100/140mm |



TKR10-D

Fixed / Fixed

| | |
|--------------|-----------------------------------|
| Spoke System | J-Bend |
| Hole Count | 20 , 24 , 28 , 32 , 36 |
| Weight | 280g ± 5g |
| Material | Aluminum |
| Gauge | 14 |
| Bearings | ◎ 2 (6000*2) |
| P.C.D | ø62 - ø62 |
| O.L.D. | 120mm |
| Axle system | 3/8" x 120/165mm, M10 x 120/165mm |



TKR10-S

Fixed / Free

| | |
|--------------|-----------------------------------|
| Spoke System | J-Bend |
| Hole Count | 20 , 24 , 28 , 32 , 36 |
| Weight | 280g ± 5g |
| Material | Aluminum |
| Gauge | 14 |
| Bearings | ◎ 2 (6000*2) |
| P.C.D | ø62 - ø62 |
| O.L.D. | 120mm |
| Axle system | 3/8" x 120/165mm, M10 x 120/165mm |

TRIKE / RECUMBENT BIKE

Steintrikes Co.
Viktor Horvatski and Robert Stein

The narrow DH12N hub for trikes that it is designed by Steintrikes for "16-18-20" wheels.



DH12N

| | |
|-----------------|----------------|
| Brake Interface | Disc (6-bolts) |
| Weight | 211g ± 5g |
| Bearings | ◎ 2 (6001*2) |
| Gauge | 14 |
| Hole Count | 20, 24, 28, 32 |
| ID | 12mm |
| Flange C-C | 34mm |
| P.C.D | ø 58 - ø 58 |

DH15N

| | |
|-----------------|--------------------|
| Brake Interface | Disc (6-bolts) |
| Weight | 204g ± 5g |
| Bearings | ◎ 2 (6902*2) |
| Gauge | 14 |
| Hole Count | 20, 24, 28, 32, 36 |
| ID | 15mm |
| Flange C-C | 34mm |
| P.C.D | ø 58 - ø 58 |

DH12M

| | |
|-----------------|----------------|
| Brake Interface | Disc (6-bolts) |
| Weight | 213g ± 5g |
| Bearings | ◎ 2 (6001*2) |
| Gauge | 14 |
| Hole Count | 28, 32, 36 |
| ID | 12mm |
| Flange C-C | 55.8mm |
| P.C.D | ø 58 - ø 58 |

DH15M

| | |
|-----------------|----------------|
| Brake Interface | Disc (6-bolts) |
| Weight | 207g ± 5g |
| Bearings | ◎ 2 (6902*2) |
| Gauge | 14 |
| Hole Count | 28, 32, 36 |
| ID | 15mm |
| Flange C-C | 55.8mm |
| P.C.D | ø 58 - ø 58 |



DH20M

| | |
|-----------------|-----------------|
| Brake Interface | Disc (6-bolts) |
| Weight | 230g ± 5g |
| Bearings | ◎ 2 (6805+6904) |
| Gauge | 14 |
| Hole Count | 28, 32, 36 |
| ID | 20mm |
| P.C.D | ø 58 - ø 58 |

Axle For DH20M With End Cap

| | |
|--------|----------|
| Weight | 83g ± 5g |
| Length | 160mm |

WHEEL CHAIR HUBS



DH12NR8

| | |
|------------|----------------|
| Weight | 210g ± 5g |
| Bearings | ◎ 2 (R8*2) |
| Gauge | 14 |
| Hole Count | 20, 24, 28, 32 |
| ID | 12.7mm (R8*2) |
| Flange C-C | 34mm |
| P.C.D | ø 58 - ø 58 |

Axle For DH12NR8

| | |
|--------|---|
| Weight | QR - 185g ± 5g (Steel) Nut - 133g ± 5g (Steel) |
|--------|---|



SK-MD01 Titanium Axle Skewer

| | |
|----------------|----------------|
| Weight | 45g ± 5g (F+R) |
| Axle Material | Titanium |
| Lever Material | A7075 |
| Parts Material | A7075 |
| Color | ■ |

SK-MD02 Titanium Axle Skewer

| | |
|----------------|----------------|
| Weight | 44g ± 5g (F+R) |
| Axle Material | Titanium |
| Lever Material | A7075 |
| Parts Material | A7075 |
| Color | ■ |

SK-MF42 Cr-Mo Axle Skewer

| | |
|----------------|-----------------|
| Weight | 118g ± 5g (F+R) |
| Axle Material | Cr-Mo |
| Parts Material | A6061 |
| Color | ■ |

SK-MF46 Cr-Mo Axle Skewer

| | |
|----------------|-----------------|
| Weight | 125g ± 5g (F+R) |
| Axle Material | Cr-Mo |
| Parts Material | A6061 |
| Color | ■ |

SK-R12 For MTB Axle 12mm

| | |
|---------------|---|
| Weight | 80g ± 5g - Skewer for SRAM 88g ± 5g - Skewer for Shimano |
| Axle Material | A7075 |
| Color | ■ |

This Skewer used for MTB Rear Hubs when with Axle 12mm.

SK-FB172-174

| | |
|---------------|----------|
| Weight | 33g ± 5g |
| Axle Material | A7075 |
| Color | ■ |

SK-G22 FOR SHIMANO

| | |
|---------------|---------------------|
| Weight | 165g ± 5g |
| Axle Material | A7075 |
| Size | 12M x 100 / 121.5mm |
| Color | ■ |

SK-G60 FOR SRAM

| | |
|---------------|-------------------|
| Weight | 100g ± 5g |
| Axle Material | A7075 |
| Size | 15M x 100 / 150mm |
| Color | ■ |



HUB FACTORY MADE IN TAIWAN

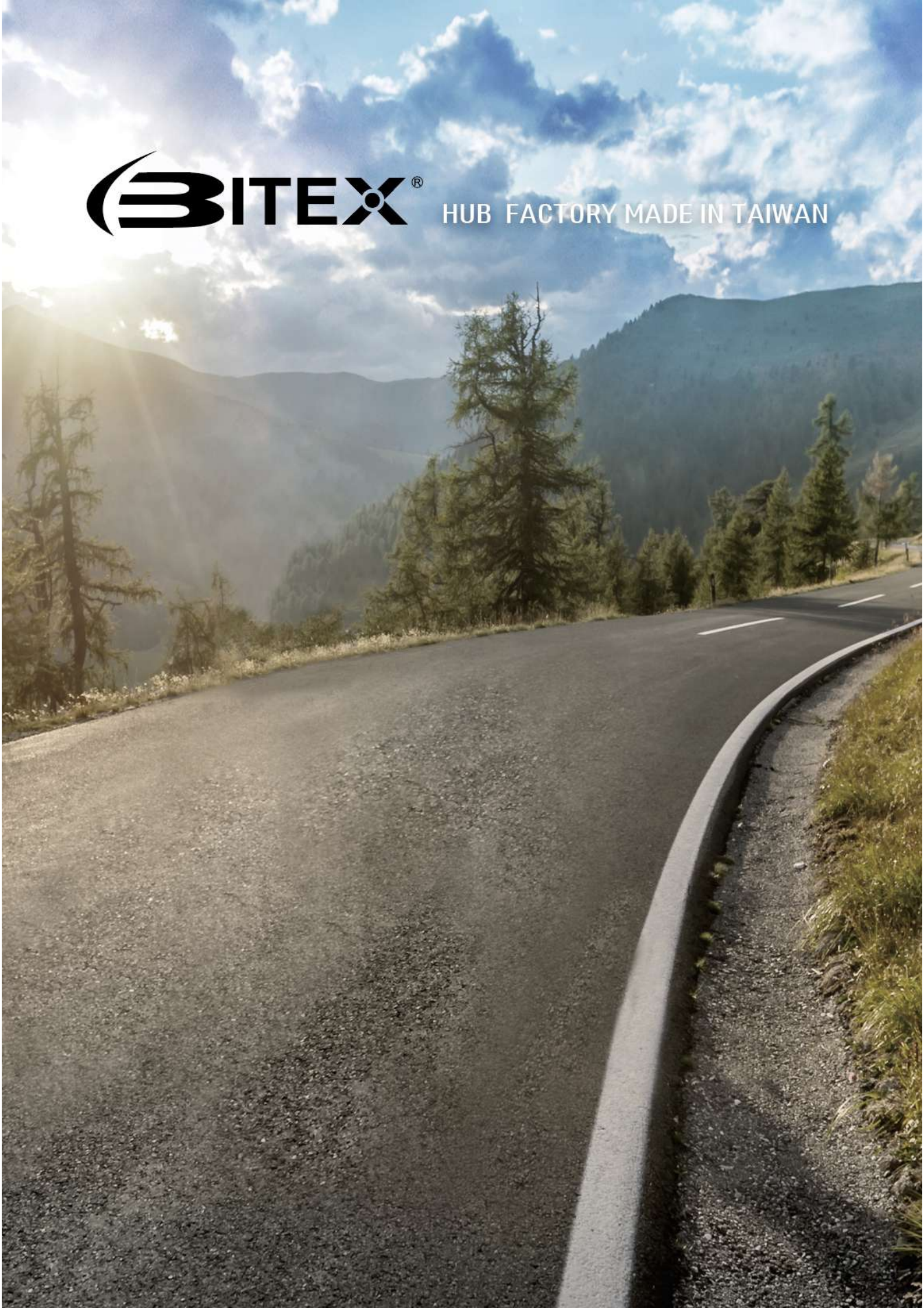



HUB FACTORY | MADE IN TAIWAN | www.bitexhubs.com



HUB FACTORY

BITEX INDUSTRIAL CO., LTD.

Tel

886 4 2452 7696

Fax

886 4 2452 7096

E-mail

min@bitexhubs.com

Add

Office No.48, Ln. 29, Fongming St., Situn Dist., Taichung 40744, Taiwan

Factory No.140-1, Nanmei Ln., Hesheng St., Shigang Dist., Taichung City 422, Taiwan